



## About St Cuthbert's

The de Lacys came to this part of Herefordshire with the Conquest in 1066; in about 1115 Hugh de Lacy gave St Cuthbert's to the monks of Gloucester. But it is the Scudamore family, who came to live here in the early 15th century and remained until 1909, that was a major influence on the parish. They rebuilt or remodelled Holme Lacy House from 1674, and were benefactors of the church, paying for repairs and new furnishings, and filling the east end of the chancel and south chapel with an impressive array of family monuments.

Why the church was built far from the village and great house is not known – the surrounding terrain is low-lying and frequently flooded. The present structure dates from the late 13th century, with the west tower added in the 14th century.

In 1909 Holme Lacy was acquired by the wealthy Australian brewer, Robert Lucas-Tooth, who gave some windows and a lectern to the church. Sadly, his sons were killed in the First World War and the estate passed through various owners in succeeding years. The isolated location of the church, coupled with the need for extensive repairs, led to its being closed; it passed into the care of The Churches Conservation Trust in June 1994.

## A thousand years of English history awaits you

The Churches Conservation Trust is the national charity protecting historic churches at risk.

We have saved over 340 beautiful buildings which attract more than 1.5 million visitors a year. With our help and with your support they are kept open and in use – living once again at the heart of their communities.



### Access

Due to their age, historic church floors can be uneven and worn, and lighting can be low level. Please take care, especially in wet weather when floors can be slippery.

### Help us do more

To protect and conserve these churches, and others like them, we need your help. If you enjoy your visit please give generously, and if you would like to become a CCT Supporter please pick up a leaflet or go to our website.



THE CHURCHES  
CONSERVATION TRUST

[visitchurches.org.uk](http://visitchurches.org.uk)

The Churches Conservation Trust  
1 West Smithfield London EC1A 9EE  
Telephone 020 7213 0660  
Registered Charity No. 258612  
© CCT 2011



your church tour

# Church of St Cuthbert

Holme Lacy, Herefordshire



THE CHURCHES  
CONSERVATION TRUST

50p



- 1 The 14th-century **tower arch**.
- 2 Two-manual **organ**, built by Norman & Beard, 1913.
- 3 Two **hatchments** (diamond-shaped panels): (a) with motto *In coelo quies* for Frances, Lady Scudamore, d.1750; (b) with motto *Scuto amoris divini* for Frances, Lady Scudamore, d.1716.
- 4 **Oak benches** and **pews** in the nave and aisle are probably 17th century; the plainer ones 19th century.
- 5 **Window glass**, by Powell & Sons, depicts the Arthurian knights Sir Galahad and Sir Bors. In memory of Sir Archibald Lucas-Tooth, 2nd Baronet, killed in 1918: the wooden cross on the window splay came from his grave in Normandy.
- 6 Early 20th-century **screen** between the nave and north transept.
- 7 **Wall monument**: Charles Scudamore-Stanhope, Captain of *HMS Caledonia*, died on active service in 1871. It depicts an angel, an anchor and chain and fully rigged sailing ships.
- 8 **Window**, probably by Edward Frampton, depicting The Good Shepherd and The Light of the World: commemorates the 9th Earl of Chesterfield (d.1887).
- 9 Stone **bowl** with lugs, probably a mortar for mixing lime. The piece of moulded stone alongside appears to be part of a doorway or window.
- 10 **Window glass**, comprising several late medieval fragments; it includes a bearded head, two female heads, a head of Christ, etc.
- 11 The first of several **monuments** to the Scudamores. This is to Jane Scudamore (d. 1699). Of marble, it records her ancestry and coat-of-arms.



- 12 Large marble **monument**: James, son of the 1st Lord Scudamore (d.1668). He was the husband of Jane (No.11) and is depicted in Roman costume, resting on a cushion. Probably by Grinling Gibbons.
- 13 The east **window** depicts the Archangel Michael weighing souls (cover). In memory of Sir Robert Lucas-Tooth, 1st Baronet (d.1915), it is by Henry Payne.
- 14 The **panelling, communion table** and **reredos** were provided by the Scudamores in the 17th century. The **communion rails** are late 19th century. A 13th-century **piscina** (basin for washing communion vessels) is in the south-east corner.

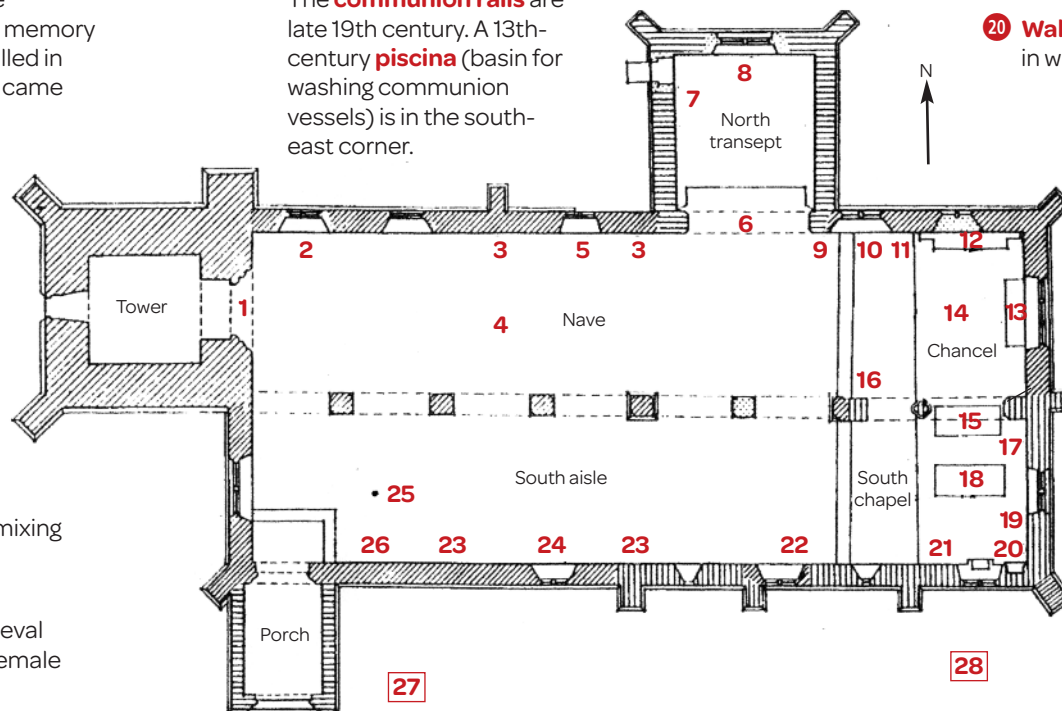

- 15 **Tomb chest**: John (d.1571) and his wife Sibell, of alabaster. The detail of his armour and her dress are especially interesting.
- 16 The gilded **lectern**, carved in the shape of an eagle, commemorates Selwyn Lucas-Tooth, killed at Le Touquet, France, in 1914.
- 17 **Wall monument**: Dorothea, Countess of Chesterfield (d.1923) by Gilbert Bayes (see also No. 28).
- 18 Two **tomb chests**: one to Frances Fitzroy-Scudamore (d.1749) and her daughter Frances, Duchess of Norfolk (d.1820). They were involved in a particularly contentious case in the Court of Chancery and are also

commemorated in a monument in the south aisle. The other is to Captain Evelyn Scudamore-Stanhope (d.1925) and depicts his regimental badge.



- 19 The east **window** of the chapel, by John Bell of Bristol, depicts St Cornelius and commemorates Captain Edwyn Scudamore-Stanhope (d.1855 in Hong Kong).
- 20 **Wall monument**: Mary Scudamore-Stanhope (d.1859) in white marble. By Matthew Noble, it depicts Faith.
- 21 An elaborate **monument** to John Scudamore, 1st Viscount of Sligo and Baron of Dromore, Ireland (d.1716). A sarcophagus with an urn, cherubs and skulls are shown; it is said to be a copy of the monument to James II of England in the Scots College in Paris.
- 22 Two sets of 15th-century **misericords** with carvings of a dog, a man in tunic and boots, horned demon and bird.
- 23 Two **hatchments**, both with motto *Sola virtus invicta*, for Charles, 11th Duke of Norfolk (d.1815) and his wife Frances (d.1820).
- 24 **Window glass** by Edward Frampton depicting The Good Samaritan; it commemorates William Scudamore-Stanhope, Vicar of Holme Lacy 1872–92.
- 25 The elegant 17th-century **font** is richly decorated with cherubs' heads.

- 26 Stone **tablet**: Henry, 11th Earl of Chesterfield (d.1935), carved by Mrs Charles Scudamore-Stanhope.
- 27 The stone **churchyard cross** is probably 14th century though part was renewed as a First World War memorial.
- 28 The south-east corner of the churchyard contains Scudamore-Stanhope family **graves**. The two elaborate wrought-iron **gates** probably came from the gardens of Holme Lacy House. The striking bronze **statue** commemorates Edwyn, 10th Earl of Chesterfield (d.1933) and was designed by Gilbert Bayes.

